

BAR DIAMETER	12	16	20	24	28	32	36
LAP LENGTH TOP BARS	500	850	1200	1550	1900	2200	2450
LAP LENGTH OTHER BARS	400	600	800	1050	1200	1350	1500

TYPE OF BAR	MINIMUM DIAMETER OF BEND (D)	MINIMUM LENGTH OF BAR (Ls) TO FORM HOOKS BAR SIZE (d mm)						
		12	16	20	24	28	32	36
FITMENTS	4d	140	170	200	230	270	300	340
OTHER BARS	5d	160	180	220	260	300	340	380
COATED BARS	8d	200	240	290	340	390	440	500

OBTUSE ANGLE BEND

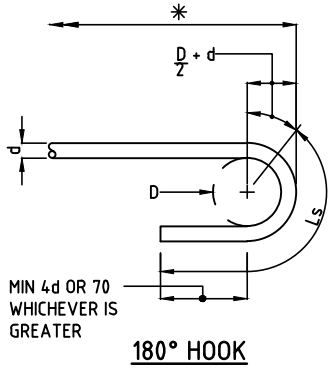

ACUTE ANGLE AND 90° BEND

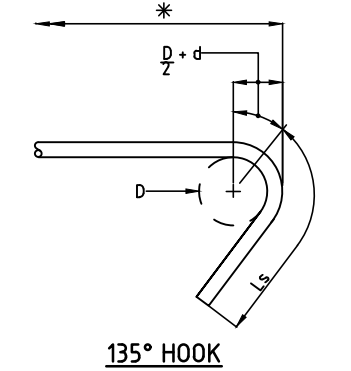

*DENOTES DIMENSION GIVEN ON BAR SCHEDULE

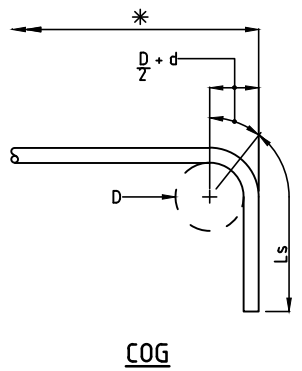

- NOTES:**
- ALL BARS DESIGNATED AS TYPE "N" SHALL BE GRADE 500N TO AS 4671-2001.
 - PROVIDE REINFORCING FABRIC TO AS 1304-1991.
 - ONLY WELD REINFORCEMENT WITH THE APPROVAL OF SUPERINTENDENT AND TO AS 1554.3-2014.
 - POSITION LAPS AWAY FROM POINTS OF MAXIMUM STRESS OR PROVIDE LAP LENGTH EQUAL TO 1.3 TIMES LENGTH GIVEN IN TABLE.
 - TIE ALL BAR INTERSECTIONS WITH 1.25mm DIA. ANNEALED WIRE.
 - DIMENSIONS ARE TO THE INTERSECTION OF STRAIGHT PORTIONS ALONG THE OUTSIDE OF BARS EXCEPT WHERE SHOWN OTHERWISE.
 - LENGTHS OF BARS ARE TO BE THE ADDITION OF APPROPRIATE OUTSIDE DIMENSIONS WITH ALLOWANCE FOR HOOKS AND COGS BUT NO ALLOWANCE FOR BENDS OR ROLLING MARGIN.
 - NS DENOTES NON STANDARD BAR SHAPE.
 - TOP BARS ARE NORMALLY HORIZONTAL BARS WITH MORE THAN 300mm OF CONCRETE BELOW THE BARS.

WARNING

BEWARE OF UNDERGROUND SERVICES. THE LOCATIONS OF UNDERGROUND SERVICES ARE APPROXIMATE ONLY AND THEIR EXACT POSITION SHOULD BE PROVEN ON SITE. NO GUARANTEE IS GIVEN THAT ALL EXISTING SERVICES ARE SHOWN.

DRAWN J.LEESON	CHECKED S.HATZI
DATE JUNE 2017	DATE JUNE 2017
DESIGNED	CHECKED
DATE	DATE
DESIGN LEADER S.HATZI	DESIGN DIRECTOR S.JACKSON
DATE 1/09/2017	DATE 1/09/2017



STANDARD DRAWINGS SAFETY BARRIERS		NORTHERN TERRITORY BRIDGES STANDARD BAR SHAPES	
FILE No.	ASSET No.	SHEET No. 1 of 1	DRAWING No. CS3204
		AMEND. 0	SHEET SIZE A1

No.	DESCRIPTION	DATE	NAME	DEPT./COMPANY
0	ISSUED AS A STANDARD DRAWING	SEPT 2017	J.LEESON	EES/DIPL
AMENDMENTS				